

**COVER SIDE**

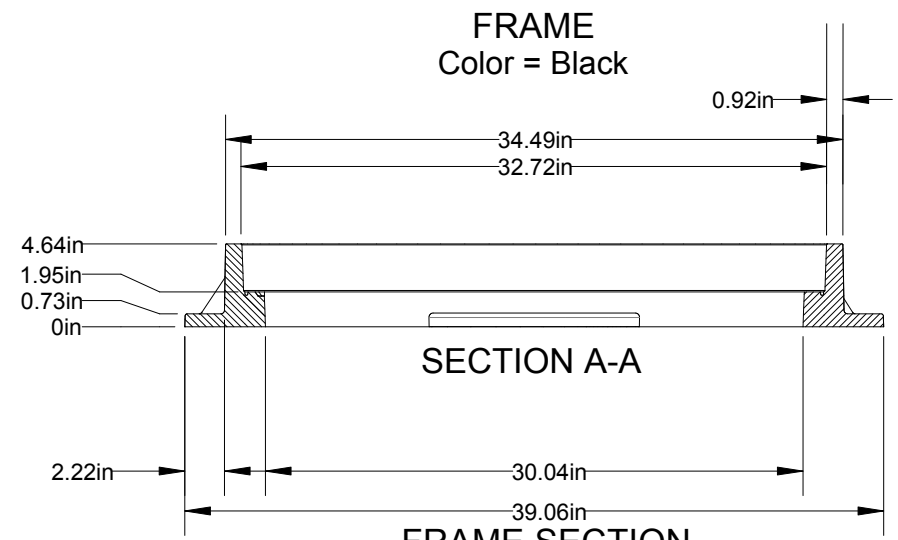

1. All hardware is 316 Stainless Steel.
2. Detectable by standard metal detectors.
3. Compression Molded Thermoset Composite - no metal reinforcement
4. PASSED M306 H20/H25 PROOF LOAD

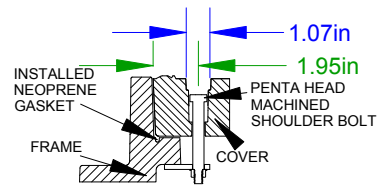
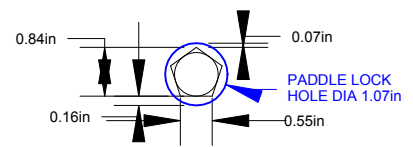

**PADDLE LOCK FEATURE**

**HOLE TO BOLT CLEARANCES**



COMPOSITE ACCESS PRODUCTS  
[www.mmg-solutions.net](http://www.mmg-solutions.net)  
[kc-sales@mmgonline.net](mailto:kc-sales@mmgonline.net)

Product Code **A-1BK30T2-C01DMDSS-H1** 2020-09-10

**Part #: CAP-30-PL-SAN**